



# *Fiberglass Ribbon Window System*



## **NEW Alpen Fiberglass Commercial Ribbon Window System**

Alpen's new Ribbon Window System combines the *look* of conventional commercial aluminum storefront and strip windows with the *performance* of **fiberglass**. Boasting full-frame thermal values from R-5.3 (U-0.19) to R-7.7 (U-0.13), air infiltration resistance 3-4x better than aluminum storefront and fiberglass frames resistant to thermal conductivity to prevent occupant discomfort, the Alpen Fiberglass Ribbon Window System is poised to disrupt the aluminum window world.

### **Features:**

- Structural capability to achieve expansive sizes and dramatic window walls
- Ultra-slim, modern profiles compliment modern design and commercial aesthetics
- Versatility allows incorporation of operable windows for natural ventilation
- Excellent sound attenuation
- Extensive range of Alpen super-insulating and directionally tuned glazing options available
- Modular design approach to installation delivers cost-effective alternative to aluminum site-assembled glazing
- Exclusive to Alpen: Suspended coated film glass technology and specialty architectural glass products can be used without sacrificing U-value. Alpen's Ribbon Window offers unique high thermal performance options including: **Spandrel, Frit, Tint, Laminated, Dynamic, Photovoltaic Glass and Daylight Redirecting Optics**

## TECHNICAL SPECIFICATIONS



### Typical Whole-Window Performance Achieved with Alpenglass™:

Alpenglass Type	Center-of-Glass			Full-Window			
	U-value	SHGC	VLТ	U-value	R-Value	SHGC	VLТ
All Climate-5	0.13	0.36	0.64	0.19	5.3	0.32	0.55
Solar Control-5	0.13	0.24	0.57	0.19	5.3	0.21	0.49
High Light-5	0.14	0.51	0.70	0.19	5.3	0.44	0.60
Solar Control-9	0.08	0.22	0.51	0.13	7.6	0.27	0.43
High Light-9	0.08	0.46	0.63	0.13	7.6	0.39	0.53

### Structural Performance:

Description	Result
AAMA A440-11 Primary Designator:	CW-PG55-FW
Air Infiltration Resistance:	0.001 cfm/ft <sup>2</sup> @ 1.57psf
Water Penetration Resistance:	No leakage at 15.04 psf (720 Pa)
Structural Test Pressure:	+/- 55.14 psf (2,160 Pa)
Forced Entry Resistance:	Grade 20

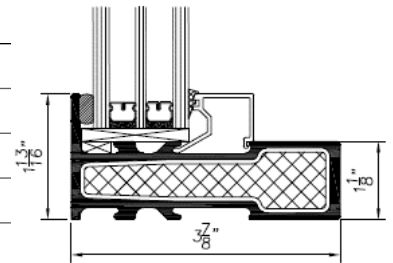

**Uses:** Fixed, Ribbon/Strip, Large “Punched” Openings and Window Walls

**Applications:** New Construction, Replacement, Residential, Commercial, Industrial & High Performance Buildings

## WINDOW STYLES: DESIGN IDEAS

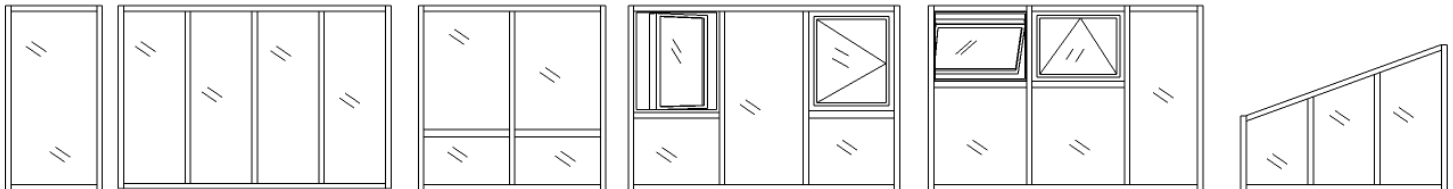

Fixed “Punched”      Fixed Ribbon With Vertical Mullions      Fixed Ribbon with Horizontal Mullions      Fixed Ribbon Combination With Casement Inserts      Fixed Ribbon Combination With Awning Inserts      Fixed Trapezoid Shapes

**Installation:** Anchor using factory- or field-applied anchor brackets supplied by Alpen HPP. Ribbons wider than 9’ typically require field-assembly and field glazing of “filler” units between each factory-assembled/factory-glazed ‘module’.

**Exterior Trim Accessories:** Aluminum Brickmold, 3-1/4” and 2-5/8” Frame Extenders

## PAINT AND FINISH OPTIONS

**Standard Colors:** Casement, Awning, Picture Windows and Sliding Patio Doors

