



Fiberglass Ribbon Window System

Alpen's Ribbon Window System combines the look of conventional commercial aluminum windows with the *performance* of **fiberglass**. Boasting full frame thermal values from R-5 (U-0.19) to R-8 (U-0.12), air infiltration resistance 3-4x better than aluminum storefront and durable fiberglass frames, the Alpen Fiberglass Ribbon Window System is poised to disrupt the aluminum window world.

Features:

- Seamlessly connect windows into expansive ribbon of glass
- Accepts Zenith operable windows for ventilation
- Modular installation method provides cost-effective alternative to site-assembled aluminum storefront
- Exclusive to Alpen: Suspended coated film glass technology and specialty architectural glass products can be used without sacrificing U-value.
- Ribbon Windows can be customized with a variety of specialty glass:

Spandrels • Frits • Tints • Laminated • Dynamic/Phase-Change • Acoustic • Daylight Redirecting

TECHNICAL SPECIFICATIONS



Uses

Strip/Ribbon and Large "Punched" Openings

Applications

New Construction, Replacement, Residential, Commercial, Industrial & High Performance Buildings

Typical Whole-Window Performance Achieved with Alpenglass™:

Alpenglass Type	Center-of-Glass			Full-Window			
	U-Factor	SHGC	VLT	U-value	R-Value	SHGC	VLT
Dual-Pane 3L	0.24	0.27	0.63	0.25	4.0	0.24	0.54
All Climate-5	0.13	0.36	0.64	0.19	5.3	0.32	0.55
Solar Control-5	0.13	0.24	0.57	0.19	5.3	0.21	0.49
High Light-5	0.14	0.51	0.70	0.19	5.3	0.44	0.60
Solar Control-9	0.08	0.22	0.51	0.13	7.6	0.27	0.43
High Light-9	0.08	0.46	0.63	0.13	7.6	0.39	0.53

Structural Performance:

Description	Result
AAMA A440-11 Primary Designator:	CW-PG55-FW
Air Infiltration Resistance:	0.001 cfm/ft ² @ 1.57psf
Water Penetration Resistance:	No leakage at 15.04psf (720 Pa)
Structural Test Pressure:	+/-55.14 psf(2,160 Pa)
Forced Entry Resistance:	Grade 20

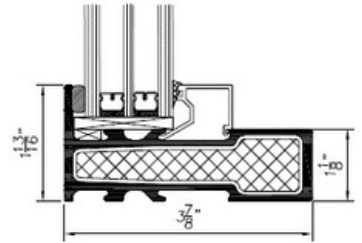

DESIGN IDEAS

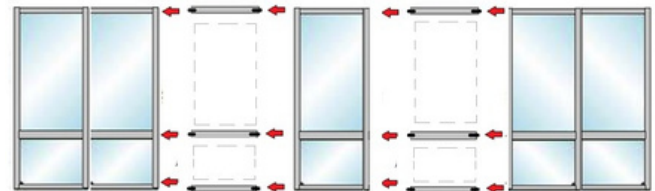
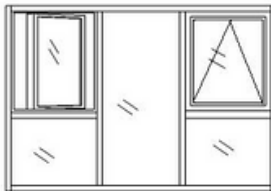
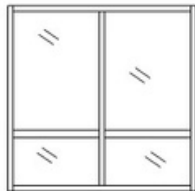

SIZES:

For optimal thermal performance, Ribbon window may be endlessly wide and up to 7' tall.

With the addition of internal steel reinforcement, window height can go up to 9' to 10' tall depending on project wind load and window design.

**Thermal performance of steel-reinforced system is not shown in data table above.*

Attachments: Anchor brackets, factory- or field-applied; Aluminum Nail Fin **Exterior Trim**

Accessories: Aluminum Brickmold, 3-1/4" and 2-5/8" Frame Extenders

FIELD ASSEMBLY:

Ribbons wider than 9' ship in a series of factory-glazed "modules" that are connected together with horizontal mullions and field-glazed.

Although assembly and installation are straightforward, it is always recommended to purchase the Ribbon Window System from an experienced professional glazier qualified to do this work.

PAINT COLORS

